

79 Factory Road, Belfast, Christchurch
 Lot 4 DP 490168
 RT: 712627
 Owner(s): Belfast Assets Limited
 Area: 6.8233ha more or less

Subject to:

- a right (in gross) to drain sewage over parts marked L, M, J, S, Q, U, V and X on DP 490168 created by Transfer **536397.1**
- a right to drain sewage over part marked B, I, Q, S, V, U, T, AA and AF on DP 490168 created by Easement Instrument **10213526.9**
- a right to drain sewage, right to convey water, electricity, telecommunications and computer media over part marked B, D, F, AB, AF, I, Q, S, V, U, T and AA on DP 490168, right of way, right to drain water and sewage, right to convey water, electricity, telecommunications and computer media over part marked J and X on DP 490168 and a right to drain sewage over part marked D on DP 490168 created by Easement Instrument **10213526.11**
- drainage easements over part herein marked F and AF on DP 490168 contained in Transfer **43839**
- drainage rights over part marked F, M, N, O, P and AF on DP 490168 created by Transfer **42287**
- **10213526.5** Consent Notice pursuant to Section 221 Resource Management Act 1991
- a right (in gross) to drain sewage over part marked B, D, F, AB, I, Q, S, V, U, T, AA, AF, J and X on DP 490168 created by Easement Instrument **10213526.8**
- Encumbrance **10194257.2**

81 Factory Road, Belfast, Christchurch
 Part Lot 47 DP 644
 RT: 785134
 Owner(s): Belfast Assets Limited
 Area: 7057m² more or less

Subject to:

- drainage rights over part within land shown as a blue line and an 8 link wide drain coloured blue on DP 1098 created by Transfers **38700**, **43839** and **70384**
- a right (in gross) to drain sewage over part marked C and G on DP 490168 created by Easement Instrument **10213526.8**
- a right to drain sewage, right to convey water, electricity, telecommunications and computer media over part marked C and G on DP 490168 and a right to drain sewage over part marked C on DP 490168 created by Easement Instrument **10213526.11**
- Encumbrance **10194257.2**

12 Fords Road, Belfast, Christchurch
 Section 5 SO 540092
 RT: 923032
 Owner(s): Belfast Assets Limited
 Area: 9.4430ha more or less

Subject to:

- a right (in gross) to drain sewage over part marked A and B SO 540092 created by Transfer **446248.1** (to be cancelled)
- a right to convey water over part marked B SO 540092 specified in Easement Certificate **A248426.7**
- Part IVA Conservation Act 1987
- Section 11 Crown Minerals Act 1991
- Encumbrance **12124425.2**

Areas, dimensions and boundaries are subject to final survey.
 A full assessment of easements will be undertaken after any engineering is completed. This may result in additional easements.

Legend:

- Existing Easement
- Proposed 2.5m Cycle Way
- 23m Esplanade Reserve Setback
- 10m Waterway Setback

MEMORANDUM OF EASEMENTS			
NATURE	SERVIENT TEN LOT NO SHOWN	DOMINANT TENEMENT	
RIGHT OF WAY, RIGHT TO DRAIN SEWAGE & WATER, RIGHT TO CONVEY WATER ELECTRICITY, TELECOMMUNICATIONS & COMPUTER MEDIA	Lot 31	A	Lot 32
	Lot 32	B	Lot 31
RIGHT TO DRAIN WATER IN GROSS	Lot 39	C	Christchurch City Council

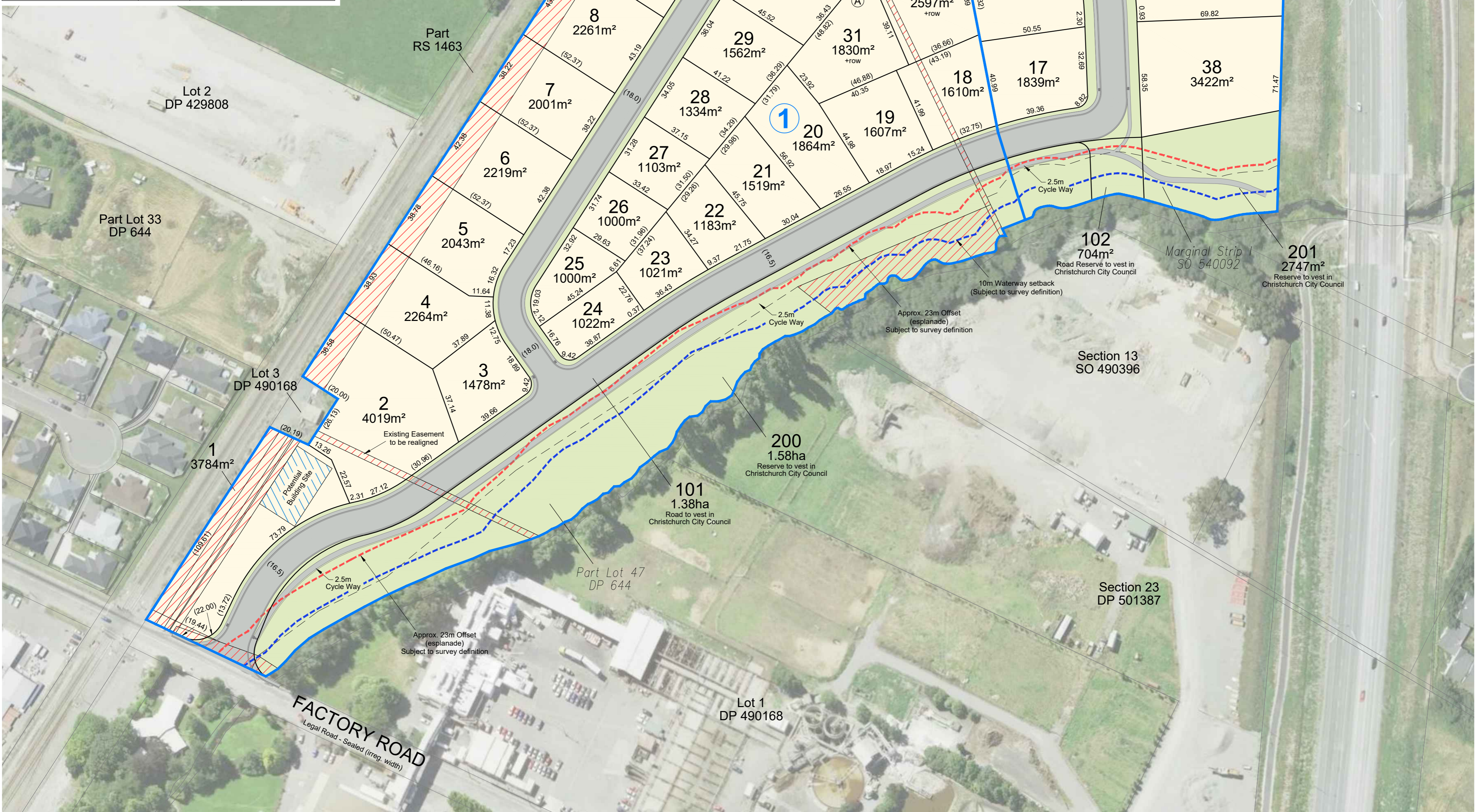

CAD ref: 42728 - Concept Plan (304N).dwg

N	12/23	Minor Footpath Amendments	RB
/ issue	/ date	/ reason	/ approved